

# Holmes Hill Road

## ST GEORGE

APPROXIMATE FLOOR AREA  
97.0 SQM / 1044 SQFT



GROUND FLOOR

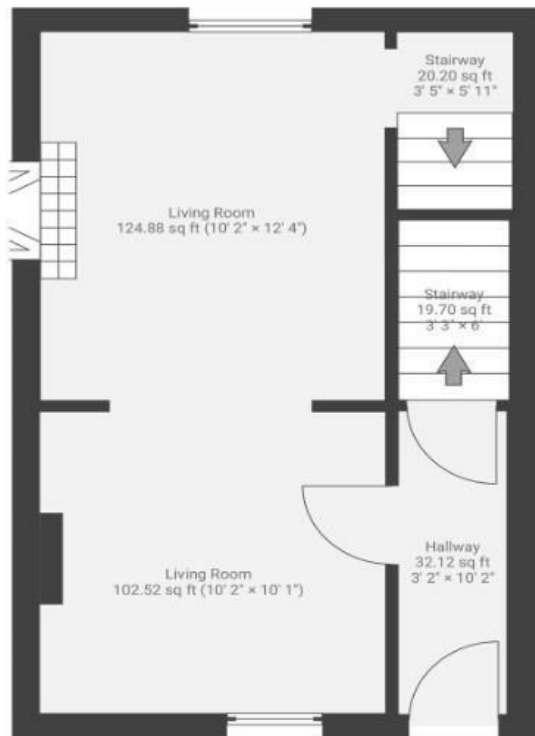

FIRST FLOOR

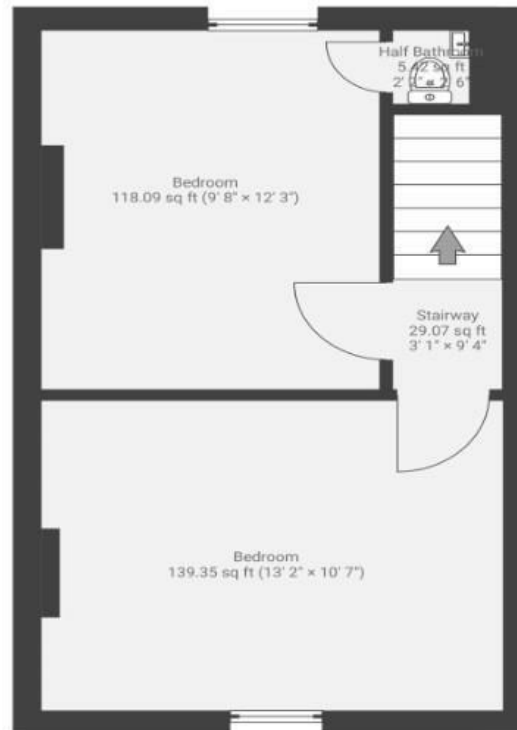

LOWER GROUND FLOOR



Illustrations are for reference purposes only, measurements are approximate, not to scale.

Boardwalk

# Holmes Hill

, BRISTOL

£

£350,000



BS5 7HH

zzz

3 Bedrooms



1 Bathrooms

*We love our house, and especially our garden. It's great having that outdoors space for the kids but also for us grownups to try and grow stuff. When it's the balloon festival we have the best view in Bristol up on the hill and our neighbours are lovely - everyone on the street is really friendly and helps each other out*

